

Hamilton Laboratory Solutions

Steel Laboratory Furniture

Construction Details



Steel Base Cabinet Without Access Panels

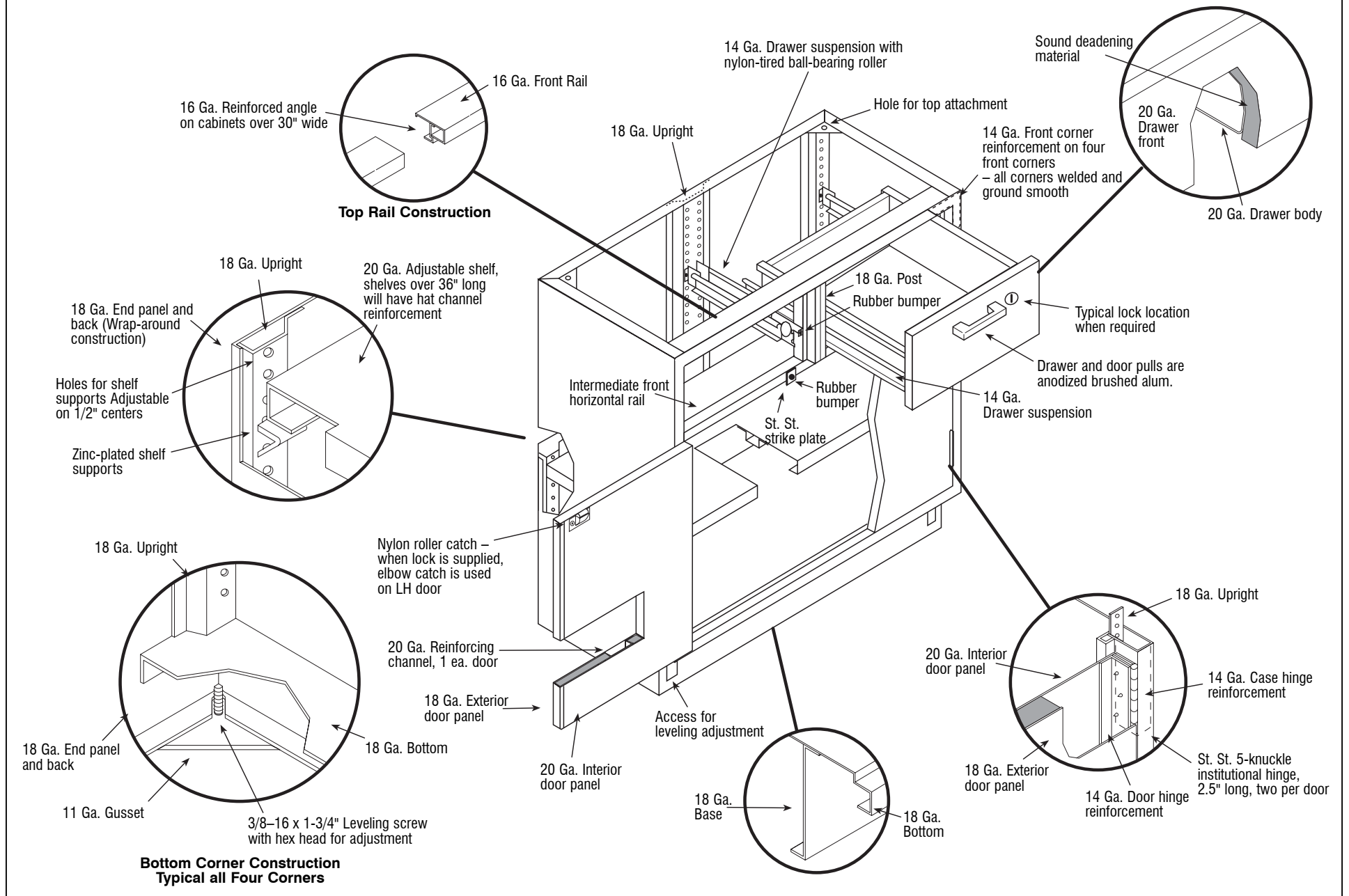

Steel Base Cabinet With Access Panels

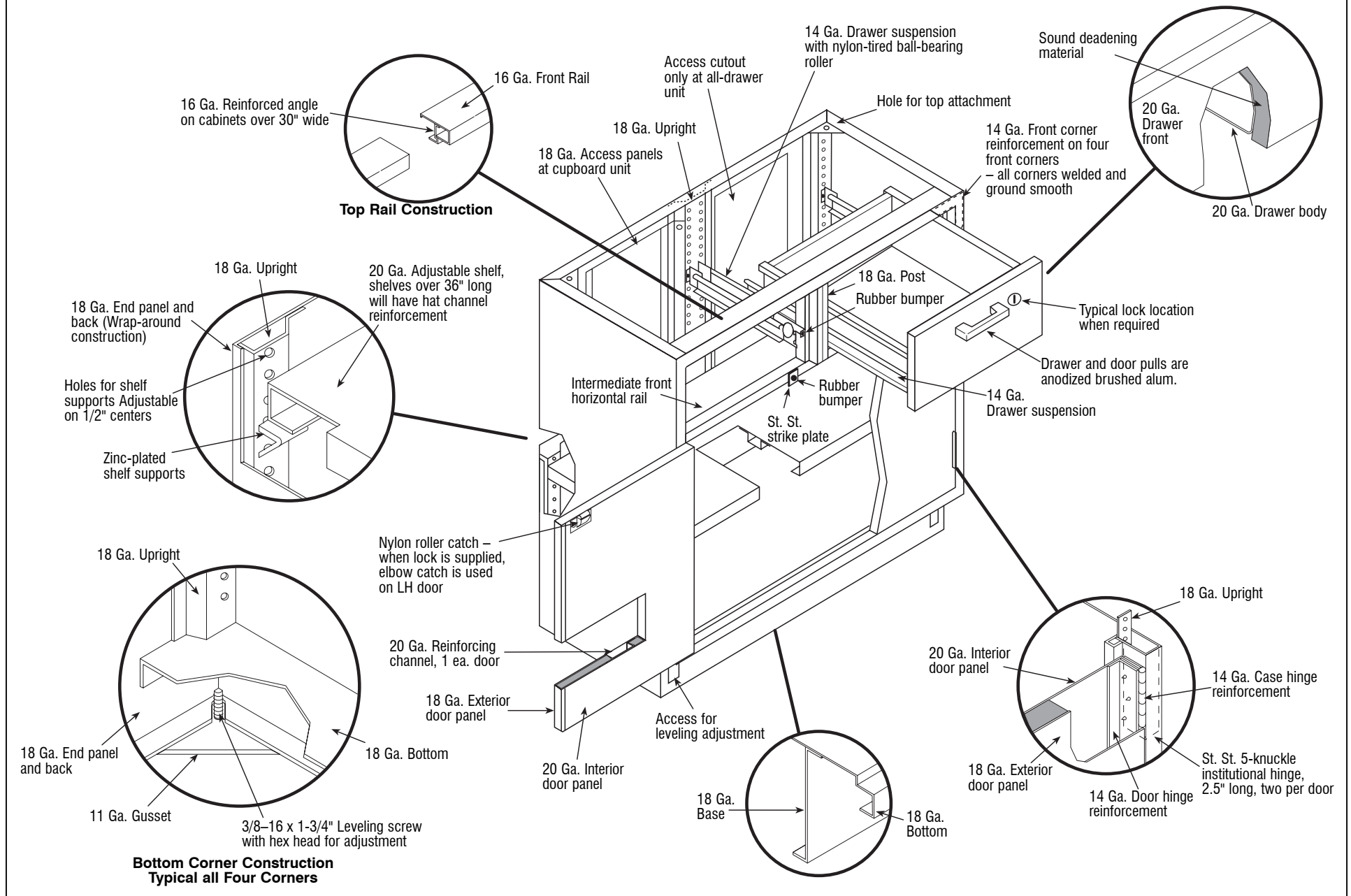

Steel Sink Base Cabinet

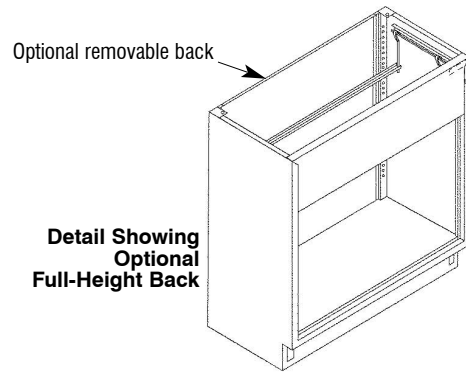

**Detail Showing
Optional
Full-Height Back**

18 Ga. Upright

18 Ga.
End panel
and back

18 Ga. Upright

18 Ga. Bottom

18 Ga. End
panel and
back

11 Ga. Gusset

3/8-16 x 1-3/4"
Leveling screw
with hex head for
adjustment

**Bottom Corner Construction
Typical all Four Corners**

11 Ga. Sink support channels
furnished only when sinks are
mounted to underside of
counter top

Hole for top attachment

Lower back rail

Rubber bumper

Door pulls are anodized
brushed alum.

16 Ga. Front Horizontal Rail

St. St.
strike plate

Nylon
roller catch

20 Ga. Reinforcing
channel, 1 ea. door

Rubber bumper

Access for
leveling adjustment

18 Ga.
Bottom

18 Ga.
Base

18 Ga. Upright

14 Ga. Front corner
reinforcement on
four front corners
— all corners welded
and ground smooth

20 Ga. Interior
door panel

Sound
deadening
material

18 Ga. Exterior
door panel

14 Ga.
Door hinge
reinforcement

St. St. 5-knuckle
institutional hinge,
2.5" long, two per
door

Steel Wall Case with Swinging Doors

25-3/16" and 31" High Wall Cases with Swinging Doors

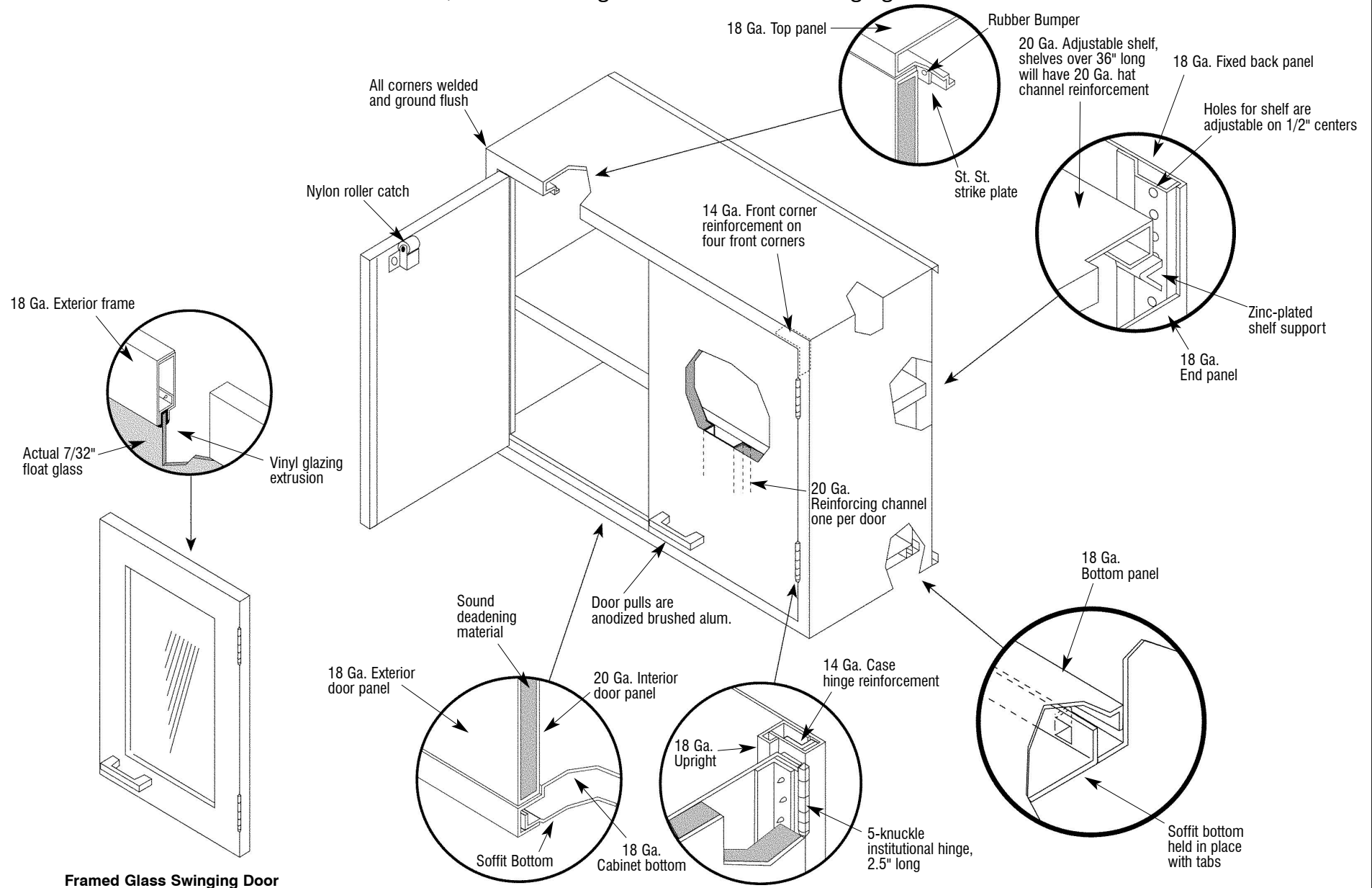

Steel Wall Case with Sliding Doors

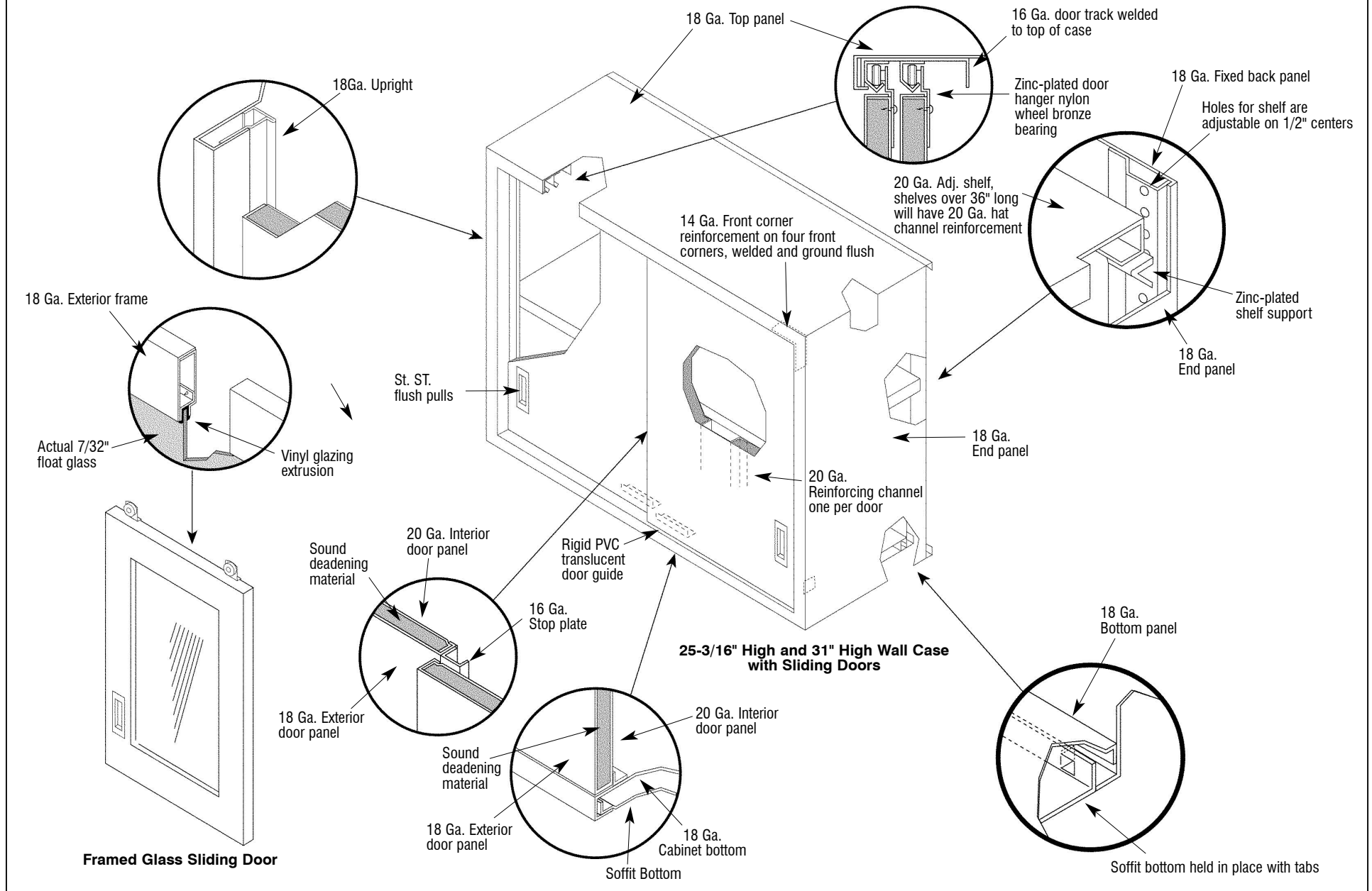

Steel Wall Case with Solid Glass Sliding Doors

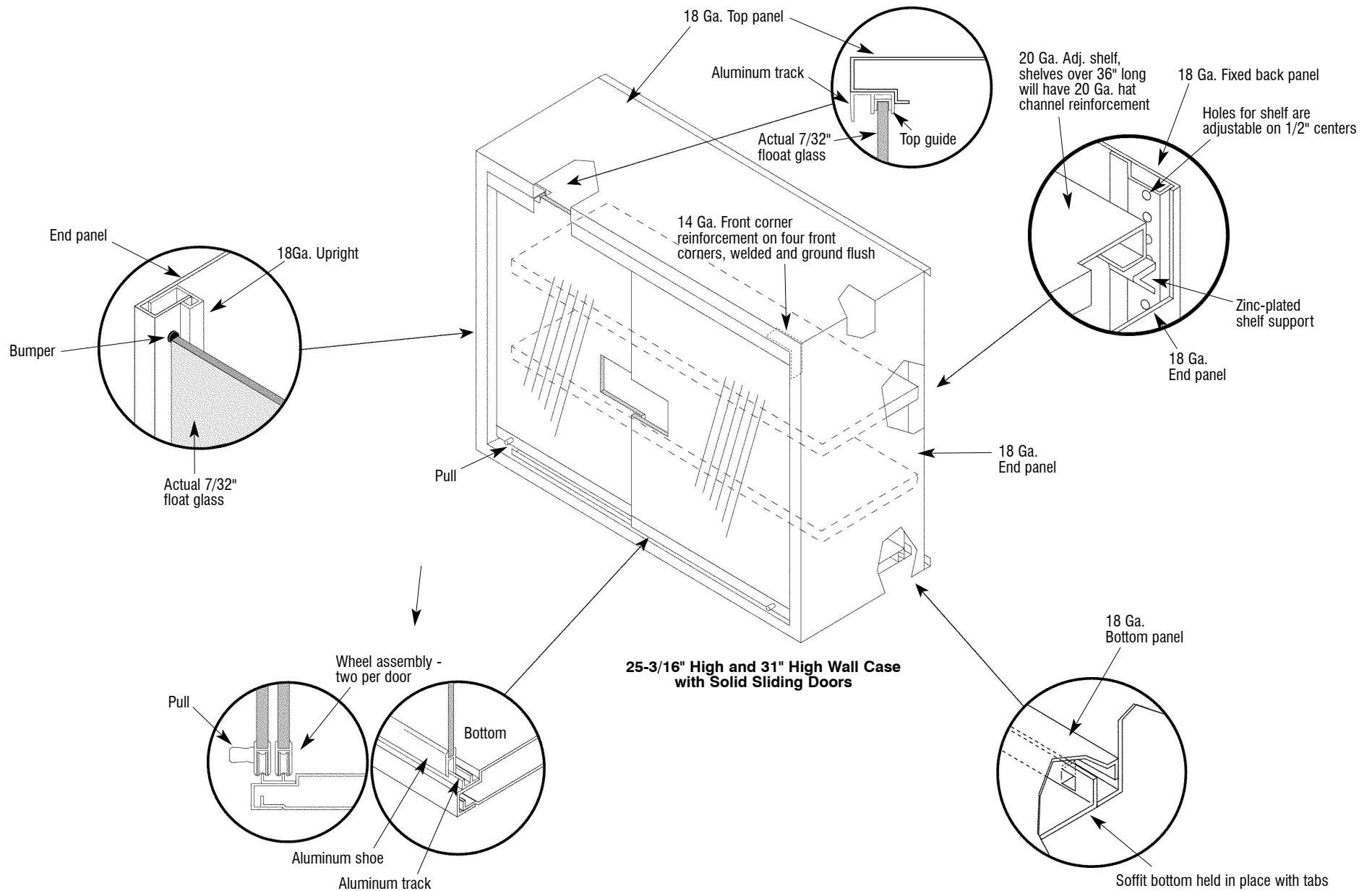

Steel Tall Case with Swinging Doors

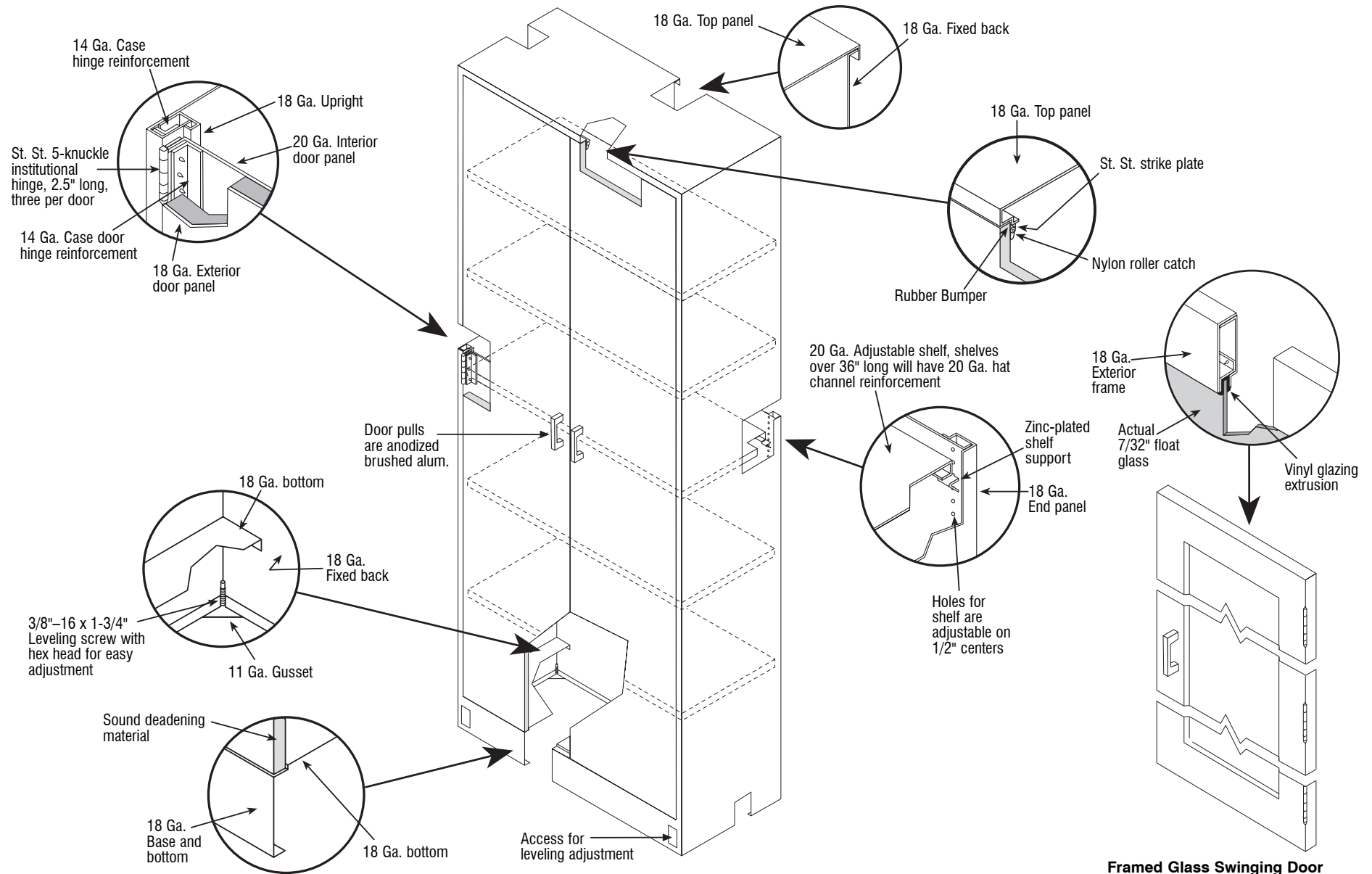

Steel Tall Case with Sliding Doors

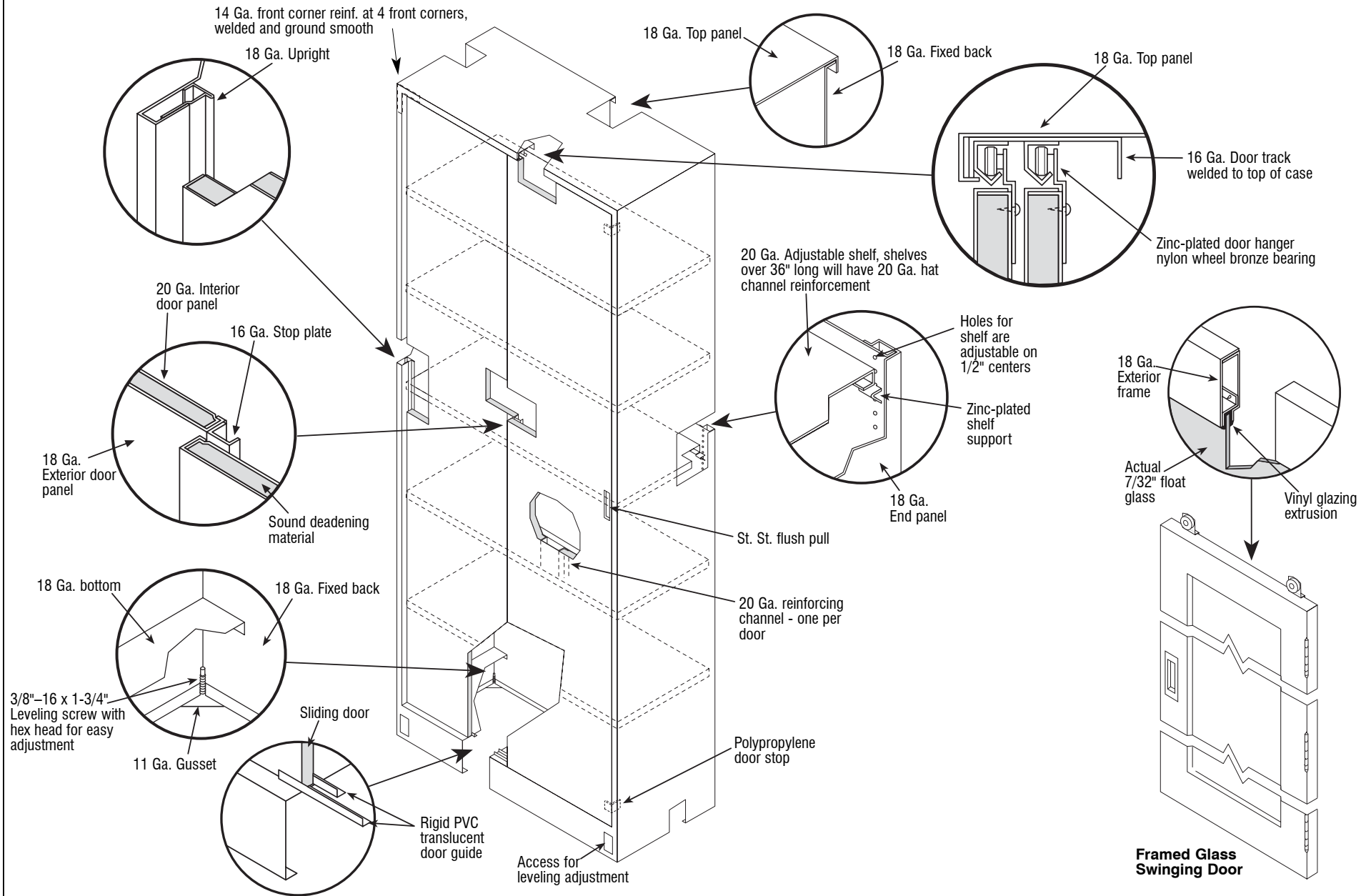

Steel Table Frame and Legs

